

CW CABLE GLAND (3 PART)

Application : For use with armoured cable, secures armouring and provides electrical continuity between armour and gland entry component. Also provides a seal on the outer sheath of the cable thus ensuring no damage to cable sheathing. These are used both indoor and outdoor, in all climatic conditions as it is weatherproof & waterproof.

Design Features : 2 part Armour / Earth Lock, Knurled Armour Lock produces a low resistance earth clip.

Also available in CIEL (Cast Intergral Earth Lug) for orders add "C" to Prod. code.

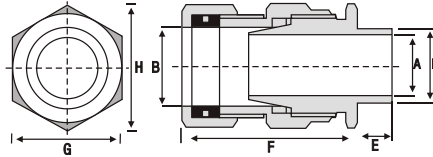

Size	Cable Dimensions Accomodate		Gland Dimensions					Product Code
	Under Armour Dia. A Max. mm	Overall Dia. B Max. mm	ISO Entry Thread Length		Approx length from shoulder F mm	Hexagon Size		
			D mm	E mm		Across flat G mm	Across corners H mm	
16 S	8.00	12.00	16.00	10.00	40.00	20.00	23.00	HCW - 16 S
16	8.60	13.50	16.00	10.00	40.00	20.00	23.00	HCW - 16
20 S	12.50	17.00	20.00	10.00	47.00	22.00	29.00	HCW - 20 S
20	14.40	20.50	20.00	10.00	47.00	26.00	29.00	HCW - 20
25 S	17.80	23.80	25.00	10.00	50.00	31.00	34.00	HCW - 25 S
25	20.40	27.00	25.00	10.00	50.00	34.00	38.50	HCW - 25
32	26.50	33.00	32.00	10.00	55.00	41.50	46.50	HCW - 32
40 S	31.00	37.00	40.00	10.00	60.00	45.00	50.00	HCW - 40 S
40	32.50	40.80	40.00	15.00	60.00	49.00	54.00	HCW - 40
50 S	37.80	45.00	50.00	15.00	65.00	51.00	64.00	HCW - 50 S
50	44.00	51.50	50.00	15.00	65.00	62.30	69.50	HCW - 50
63 S	50.50	60.50	63.00	15.00	70.00	70.00	78.00	HCW - 63 S
63	56.50	65.50	63.00	15.00	70.00	76.30	85.00	HCW - 63
75 S	62.50	72.00	75.00	15.00	75.00	85.00	95.00	HCW - 75 S
75	67.50	78.50	75.00	15.00	75.00	91.00	112.00	HCW - 75
90 S	76.00	85.00	90.00	20.00	90.00	100.00	110.00	HCW - 90 S
90 L	78.00	90.00	90.00	20.00	90.00	103.00	115.00	HCW - 90 L

CW GLAND (4 PART)

Similar in application and design to the CW (3 part) gland. However an extra component is added, a cone ring. This prevents rotation of the wire and is used instead of a knurled cone.