

## DMC Conical / Hexagonal Type Busbar Supports

Dimensions (mm)

Cat. No	Insert Size	Ø	H	A/F
EFC/H-20xM6	M6	19	20	20
EFC/H-25xM6	M6	19	25	20

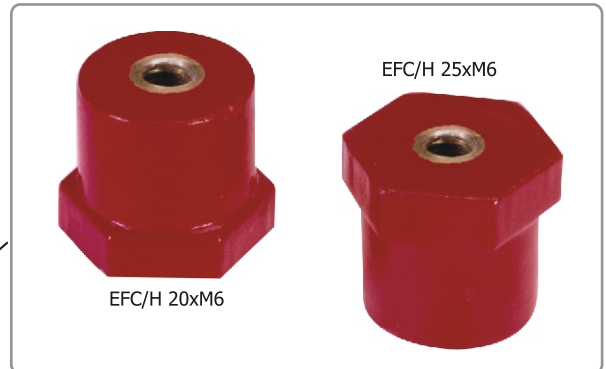
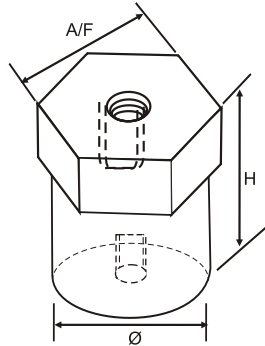

## DMC Conical Type Busbar Supports

Dimensions (mm)

Cat. No.	Insert Size	Ø1	Ø2	H
EFC-30xM6	M6	30	26	30
EFC-30xM6 Type2	M6	27	20	30
EFC-30xM8	M8	30	26	30
EFC-40xM6	M6	40	33	40
EFC-40xM8	M8	40	33	40
EFC-40xM8 Type2	M8	35	30	40
EFC-40xM10	M10	40	33	40
EFC-50xM8	M8	50	38	50
<b>EFC-50xM10</b>	<b>M10</b>	<b>50</b>	<b>38</b>	<b>50</b>
EFC-50xM12	M12	50	38	50
EFC-60xM10	M10	50	38	60
EFC-60xM12	M12	50	38	60
EFC-70xM12	M12	55	45	70
EFC-75xM12	M12	55	45	75
EFC-80xM12	M12	55	45	80

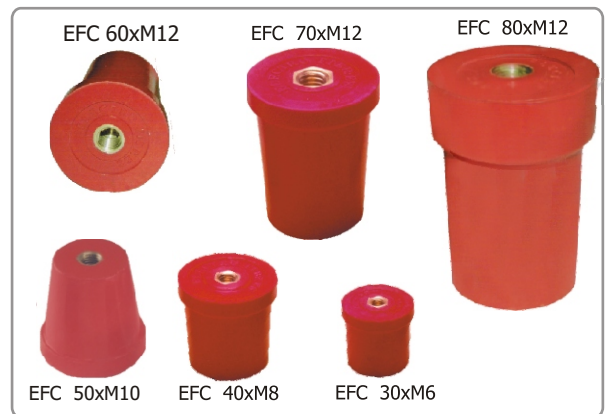
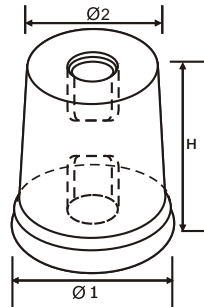

## DMC Cylindrical Type Busbar Supports

Dimensions (mm)

Cat. No.	Insert Size	Ø	H
EFCY-30xM6x4	M6	40	30
EFCY-35xM6x4	M6	40	35
EFCY-40xM6x4	M6	40	40
EFCY-45xM6x4	M6	40	45
EFCY-50xM6x4	M6	40	50
EFCY-55xM6x4	M6	40	55
EFCY-60xM6x4	M6	40	60
EFCY-65xM6x4	M6	40	65
EFCY-70xM6x4	M6	40	70

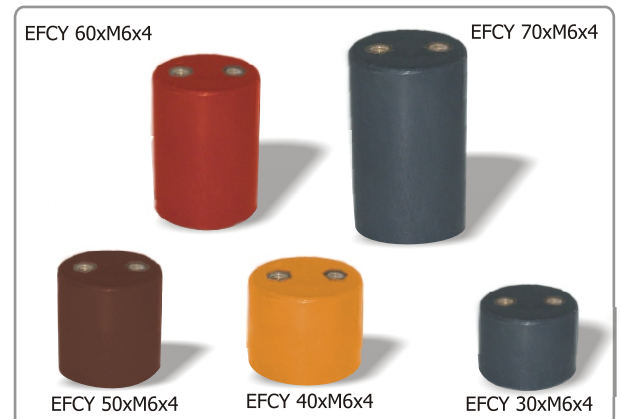
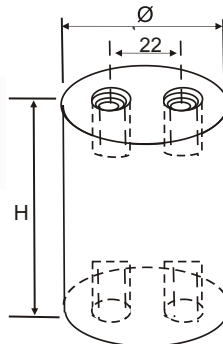

The standard size of Brass inserts used in DMC Conical / Cylindrical / Hexagonal supports are in Lengths of M6x7 , M6x9 , M6x11 , M8x11 , M10x14.5 & M12x16 L

**EMPIRE TRADING AGENCY(PVT)LTD**

NO.110, LAYARDS BROADWAY,  
COLOMBO 14,  
SRI LANKA.  
TEL : 011 2433047, 011 2343701,011 5330470-71,  
FAX : 011-2431180  
E-MAIL : empita@slt.lk  
WEB : www.empiretradingagency.lk